

TOTAL EXTENT (AS PER PATTI) : 6600 SQ.M
ROAD AREA : 2255 SQ.M
TOTAL NO. OF PLOTS : 48 Nos.

NOTE:

1. SPLAY - 3.0M x 3.0M, 1.5M x 1.5M
2. MEASUREMENTS ARE INDICATED EXCLUDING SPLAY DIMENSIONS
3. ROAD AREA WAS HANDED OVER TO THE LOCAL BODY VIDE GIFT DEED DOC. No:14978/2018, DATED:13.12.2018, SRO @ AVADI

CONDITIONS:

- (1) THE FOLLOWING CONDITIONS OF PWD VIDE THE CE, WRD, PWD, CHENNAI REGION, CHEPAUK, CHENNAI-5, LETTER NO.DB/TS(3)I-THIRUNINRAVUR-II/2018/M/29.10.2018 ARE TO BE COMPLIED BY THE APPLICANT BEFORE SANCTION OF THE LAYOUT.
 1. THE PROCESS OF EARTH FILLING AND COMPACTION SHOULD BE DONE IN LAYERS OF NOT MORE THAN 0.30 METRE DEPTH TO ACHIEVE THE REQUIRED DEGREE OF COMPACTION AND THE APPLICANT LAND SHOULD BE RAISED TO A LEVEL OF (+)10.000M. THE DEPTH OF FILLING VARYING FROM 1.260M TO 1.660M VARYING FILLING OF THE ENTIRE AREA OF THE APPLICANT LAND TO AVOID INUNDATION DURING MAXIMUM FLOOD PERIODS.
 2. THE APPLICANT SHOULD PROVIDE ADEQUATE DEWATERING ARRANGEMENTS TO BAIL OUT THE WATER WITHIN THE PREMISES AND NECESSARY DRAINAGE FACILITIES MUST BE PROVIDED AS THE SITE IS RELATIVELY AT A LOWER LEVEL AND MORE PRONE TO INUNDATION.
 3. THE APPLICANT PROTECTIVE MEASURES SHOULD BE TAKEN TO AVOID ENTRY OF STORM WATER FROM THE ROAD.
 4. SEWAGE AND SULLAGE WATER SHOULD NOT BE LET IN THE CHANNEL AND NECESSARY SEWAGE TREATMENT PLANT ARRANGEMENTS SHOULD BE CONSTRUCTED AS PER POLLUTION CONTROL BOARD NORMS AT PROPOSED SITE BY PROMOTER.
 5. THE APPLICANT SHOULD PROVIDE RAINWATER - HARVESTING ARRANGEMENTS IN THE SITE PROPOSED AT HIS OWN COST.
 6. THE PWD OFFICIALS SHOULD BE ALLOWED TO INSPECT THE SITE AT THE TIME CONSTRUCTION OF CULVERT AND THE CULVERT DRAWING SHOULD BE GET APPROVED BY THE EXECUTIVE ENGINEER, PUBLIC WORKS DEPARTMENT, WATER RESOURCES DEPARTMENT, THIRUVALLUR.
 7. THE APPLICANT SHOULD ABIDE BY THE RULES AND REGULATIONS OF THE PWD FROM TIME TO TIME.
 8. THE APPLICANT SHOULD NOT ENCROACH INTO ADJACENT CHANNEL LAND AND CLEARLY DEMARCAT E BOUNDARIES BEFORE STARTING DEVELOPMENT ACTIVITIES.
- F A I L I N G TO COMPLY WITH ANY OF THE ABOVE CONDITIONS, PWD/WRD RESERVES RIGHTS TO WITHDRAW THE TECHNICAL OPINION ON INUNDATION POINT OF VIEW TO ABOVE PROPOSED SITE AND IN THAT EVENT, THE APPLICANT SHALL NOT BE ELIGIBLE FOR ANY COMPENSATION WHAT SO EVER AND LEGAL ENTITY.
- (II) DR RULE NO: 29 (11)
- THE COST OF LAYING IMPROVEMENTS TO THE SYSTEMS INRESPECT OF ROAD, WATER SUPPLY, SEWERAGE, DRAINAGE OR ELECTRIC POWER SUPPLY THAT MAY BE REQUIRED AS ASSESSED BY THE COMPETENT AUTHORITY, SHALL BE BORNE BY THE APPLICANT.

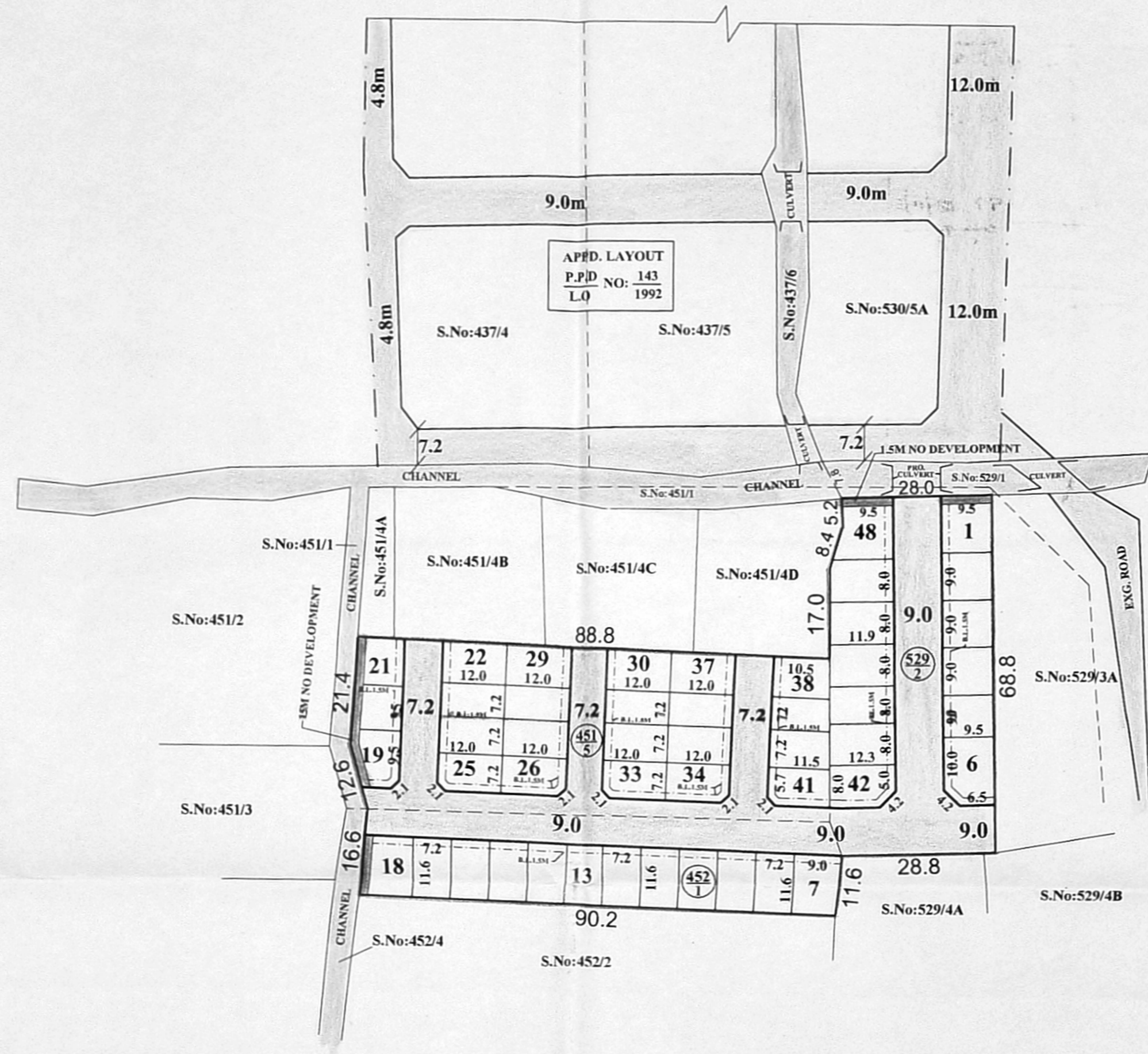

LEGEND:

- ▬ SITE BOUNDARY
- ▬ ROADS GIFTED TO THE LOCAL BODY
- ▬ EXISTING ROAD
- ▬ CHANNEL
- ▬ NO DEVELOPMENT

CONDITIONS:

THE LAYOUT APPROVED IS VALID SUBJECT TO OBTAINING SANCTION FROM THE LOCAL BODY CONCERNED.

P.P.D NO: 05
L.O 2019
APPROVED
VIDE LETTER NO : L1/17076/2018
DATE : /01/2019

FOR MEMBER SECRETARY
CHENNAI METROPOLITAN
DEVELOPMENT AUTHORITY

PREPARED BY P.A-IV (S.M)

CHECKED BY P.A.II (N.B.V)

A.P.(S.A)

POONAMALLEE PANCHAYAT UNION

LAYOUT OF HOUSE SITES IN S.Nos: 451/5, 452/1 & 529/2 OF THIRUNINRAVUR -B VILLAGE.

SCALE : 1:800 (ALL MEASUREMENTS ARE IN METRE)

